



**BEST PRACTICE GUIDE – FLASHING/WALL TIE/ WEEPHOLE – COMPLIANCE  
AND BEST PRACTICE – DIAGRAMS**

**May 29<sup>th</sup> 2019**

Top of veneer panels  
(Within 300mm or 2 courses, whichever is the lesser)

Weephole  
(Placed directly above cavity flashing. Min. 50mm height  
x Vertical mortar joint width. Spaced @ Max 1200mm  
Centers)

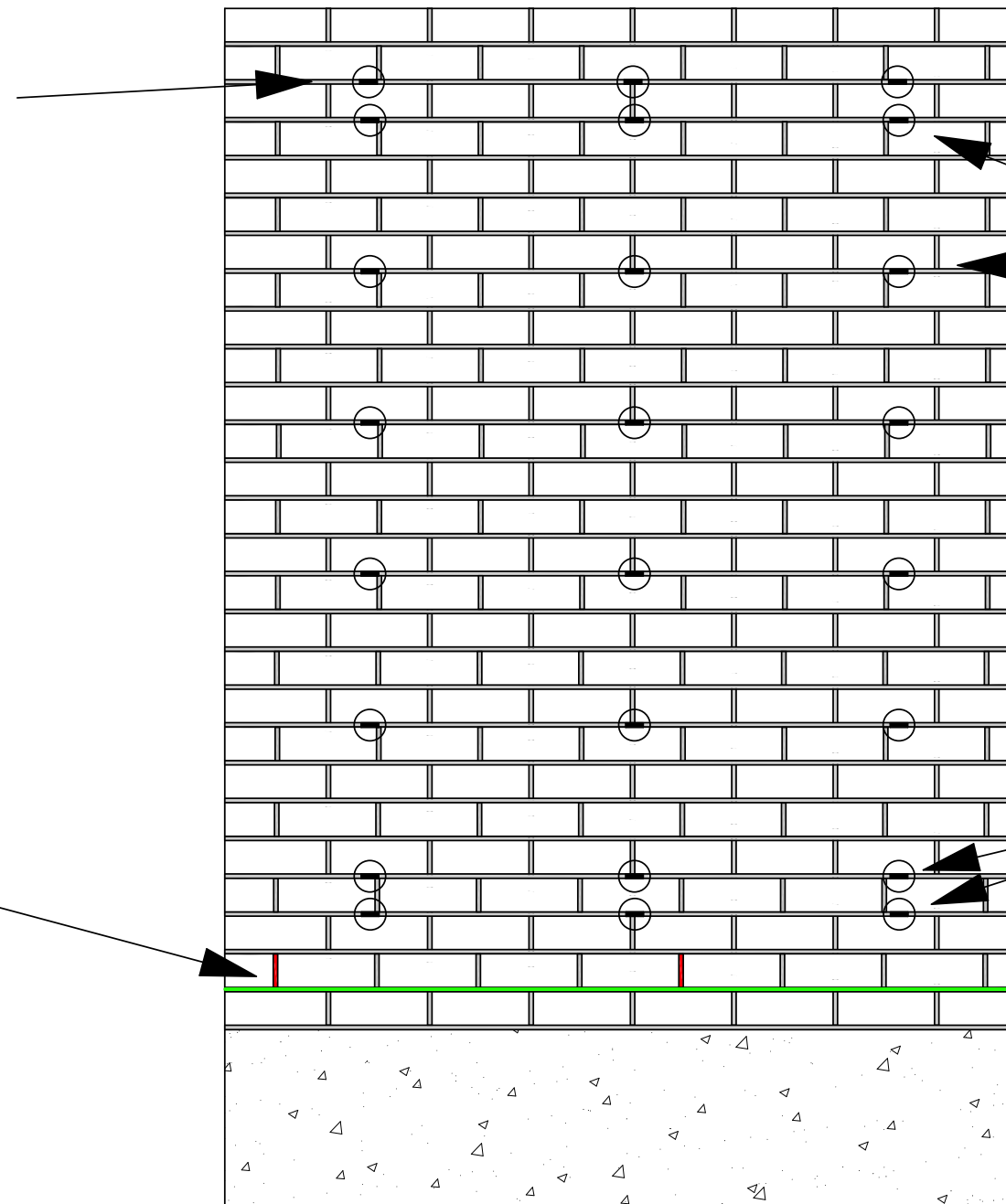

Vertical Wall tie spacings  
(Maximum 400mm centers vertically)

Bottom of veneer panel  
(Wall ties in each of the first two brick  
courses. Spaced max 600mm centers)

Structural Floor Level 0c  
Homeguard DPC - 1c  
Footing Height -2c

600mm max centers horizontally  
(450mm centers for wall stud spacing of 450mm)

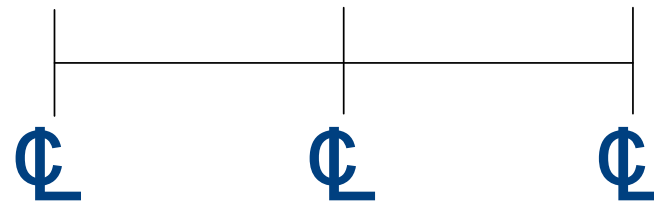

Medium Duty Wall Tie Spacings

Brickties - Edges of Openings - 10 ties per m<sup>2</sup>  
(Within 300mm of panel side or edge. 300mm x 300mm Vertical and Horizontal Max Centers)

**Sill Flashing - Polycourse**

(Extending 150mm min. each side of the opening.  
Located not more than 1 course below sill brick.  
Embedded 30mm min into exterior masonry veneer.  
Attached to window. Weepholes not required beneath window/door sills)

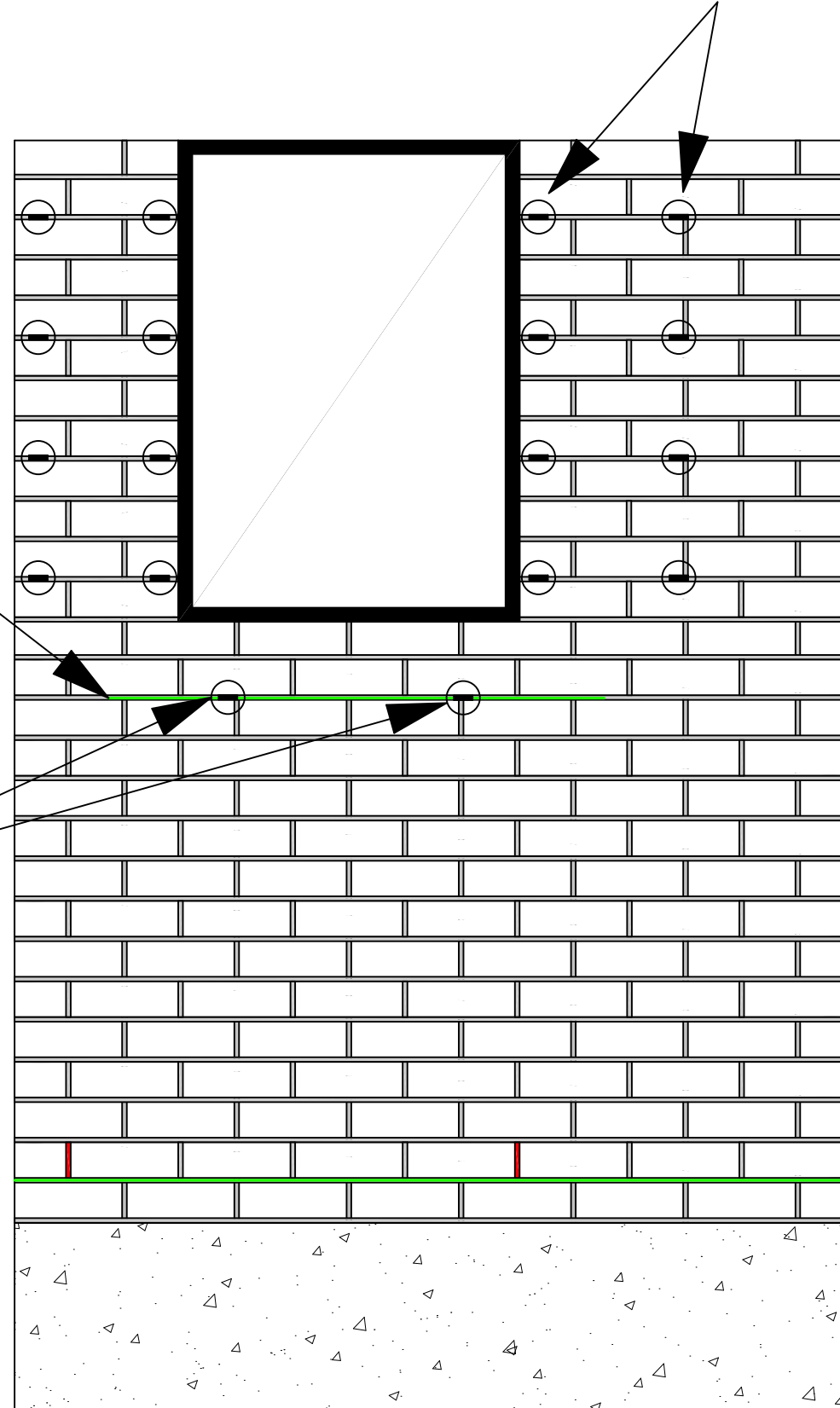

**Top of Panels under openings**

(Within 300mm or 2 courses - whichever is the lesser - from the top of the veneer)

← Structural Floor Level 0c

600mm max centers horizontally  
(450mm centers for wall stud spacing of 450mm)

**Medium Duty Wall Tie Spacings - Window/Door Openings**

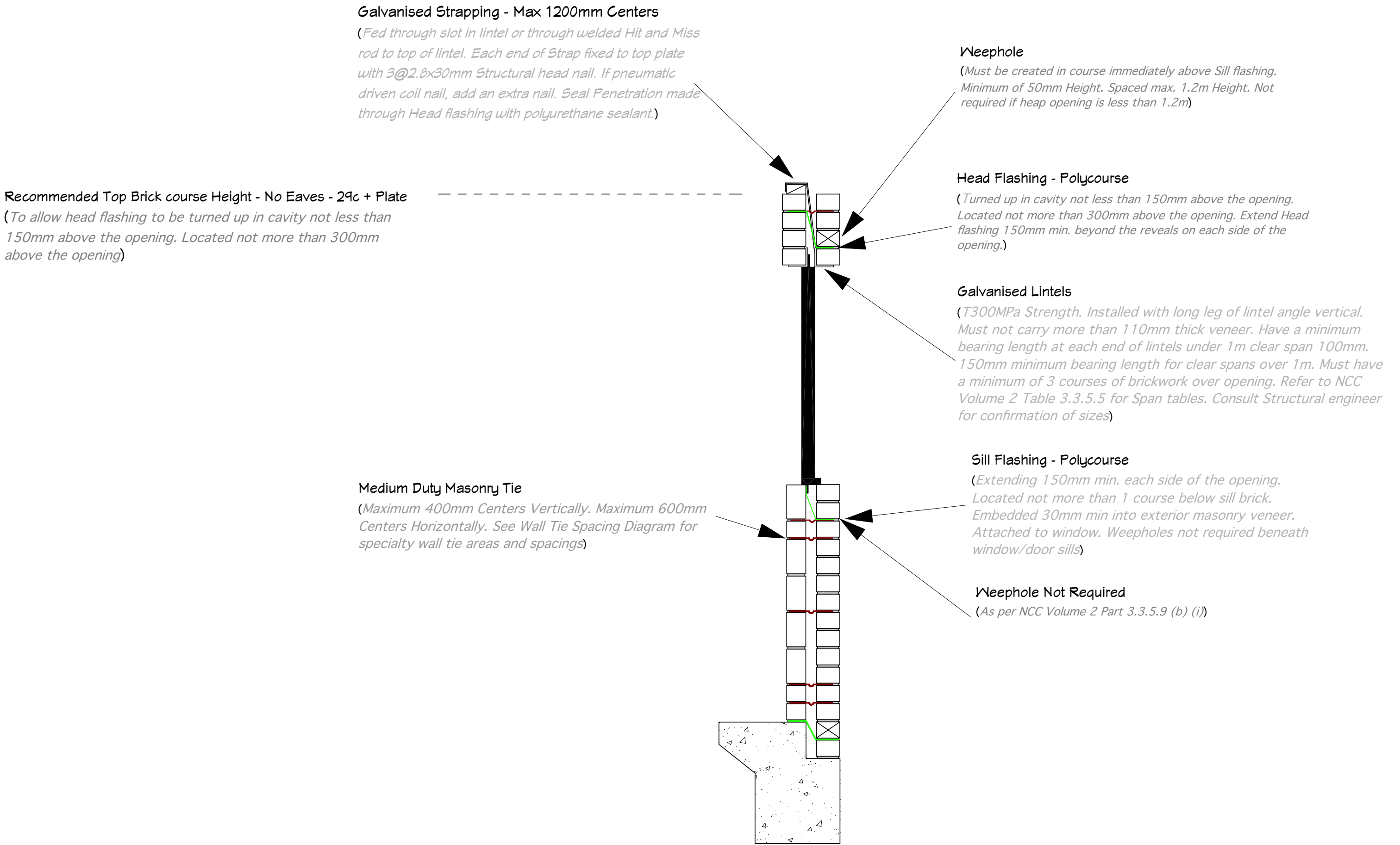

**Medium Duty Wall Tie Spacings - Window/Door Openings - Side View**  
 (Double Masonry Veneer)

**Low Expansion Spray foam/Fire Rate Polyurethane Caulking**  
(Seal any gaps between framing and Insulation with low expansion spray foam. For gaps Less than 6mm Use Fire Rated Polyurethane Caulking)

**Foilboard Superior 40 Rigid Insulation**  
(Rigid Insulation Adhered to Back of Lintel with Low expansion Foam)

**Weephole**  
(Must be created in course immediately above Sill flashing. Minimum of 50mm Height. Spaced max. 1.2m Height. Not required if heap opening is less than 1.2m)

**Head Flashing - Polycourse**  
(Turned up in cavity not less than 150mm above the opening. Located not more than 300mm above the opening. Extend Head flashing 150mm min. beyond the reveals on each side of the opening.)

**Galvanised Lintels**  
(T300MPa Strength. Installed with long leg of lintel angle vertical. Must not carry more than 110mm thick veneer. Have a minimum bearing length at each end of lintels under 1m clear span 100mm. 150mm minimum bearing length for clear spans over 1m. Must have a minimum of 3 courses of brickwork over opening. Refer to NCC Volume 2 Table 3.3.5.5 for Span tables. Consult Structural engineer for confirmation of sizes)

**Sill Flashing - Polycourse**  
(Extending 150mm min. each side of the opening. Located not more than 1 course below sill brick. Embedded 30mm min into exterior masonry veneer. Attached to window. Weepholes not required beneath window/door sills)

**Weephole Not Required**  
(As per NCC Volume 2 Part 3.3.5.9 (b) (i))

**Medium Duty Masonry Tie**  
(Maximum 400mm Centers Vertically. Maximum 600mm Centers Horizontally. See Wall Tie Spacing Diagram for specialty wall tie areas and spacings)

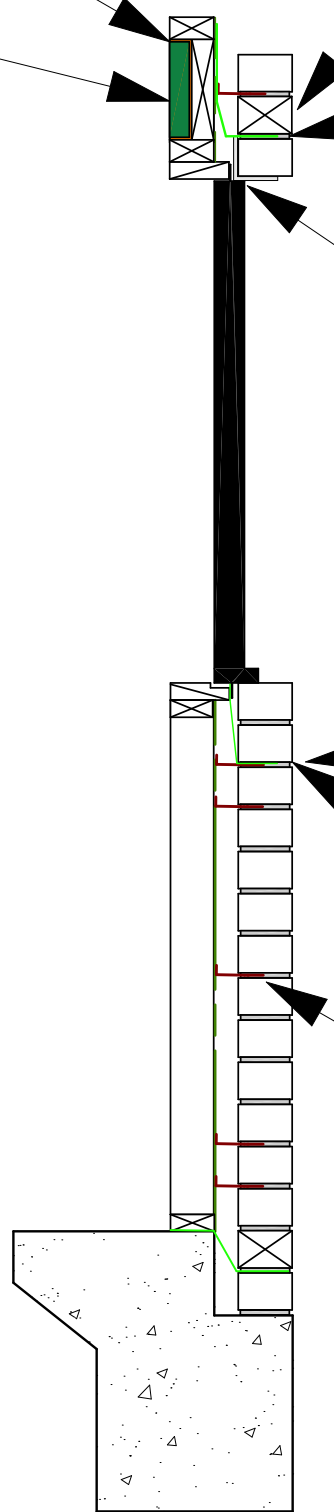

**Medium Duty Wall Tie Spacings - Window/Door Openings - Side View**  
(Timber Framed Brick veneer)

The material **may not** be reproduced or **distributed**, in whole or in part, **without** the prior written **permission** of the Apollo Homes & Development Pty Ltd. Any other reproduction or **distribution**, in whatever form and by whatever media, is expressly prohibited **without** the prior written **consent** of the Apollo Homes & Development Pty Ltd.

References:

- NCC Volume 2 – Part 3.3 - Masonry